

Composer¹ ist ein Programm um in einem Projekt neue PHP-Bibliotheken einzufügen oder verwendete PHP-Bibliotheken auf dem aktuellen Stand zu halten.

Unter Windows wird Composer mit Composer-Setup.exe installiert.

Composer muss wissen wo PHP installiert ist

Vor dem Installieren werden die Eingaben noch einmal angezeigt.

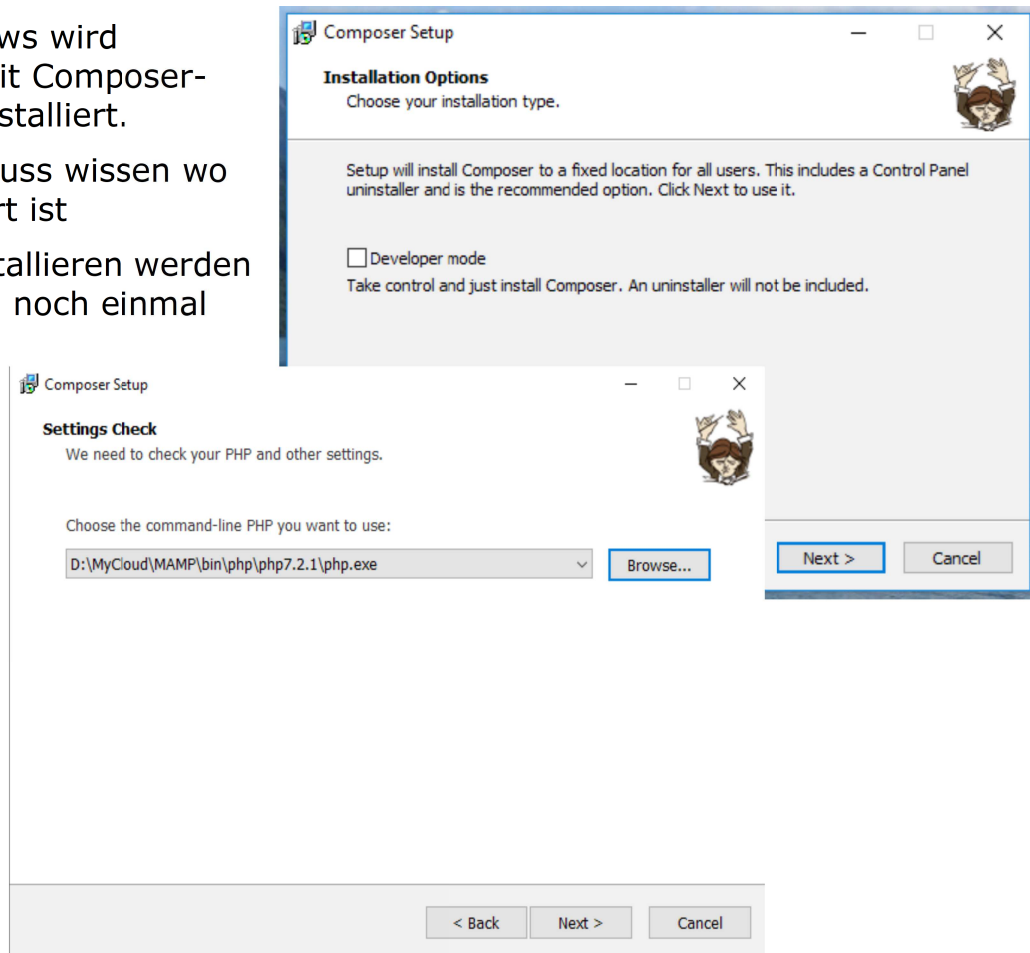

Nach der Installation weist Composer darauf hin, dass die Pfad-Angaben angepasst wurden und dass diese Änderungen erst nach einem erneuten Start von Programmen zum Tragen kommen. `.ini`

Die Installation kann in der Eingabeaufforderung überprüft werden:

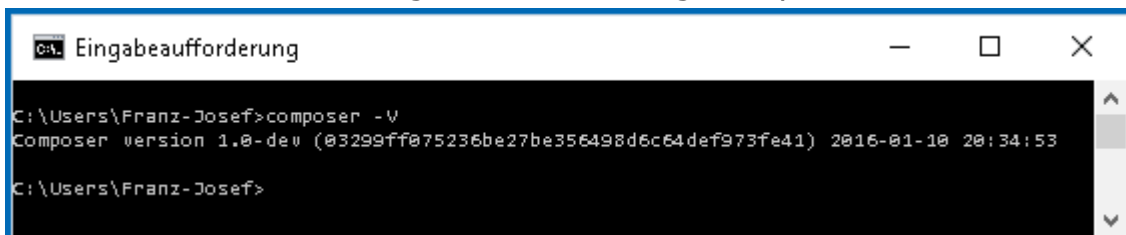

Mögliche Parameter von Composer sind auf der nächsten Seite aufgeführt.

Mit Vorteil wird von Zeit zu Zeit die Aktualität von Composer überprüft:

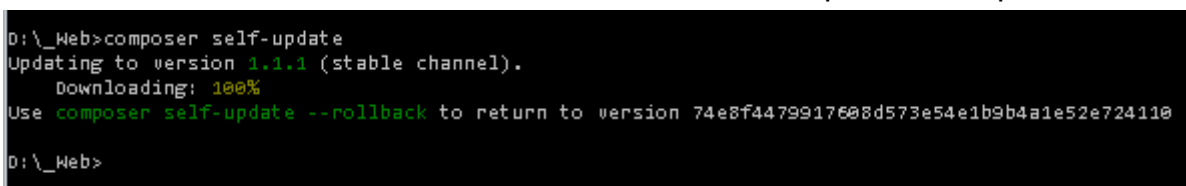

¹ <https://getcomposer.org/>

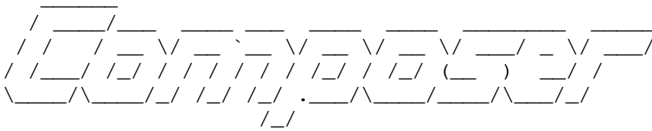

Composer version 1.10.1 2020-03-13 20:34:27

Usage:

command [options] [arguments]

Options:

-h, --help	Display this help message
-q, --quiet	Do not output any message
-V, --version	Display this application version
--ansi	Force ANSI output
--no-ansi	Disable ANSI output
-n, --no-interaction	Do not ask any interactive question
--profile	Display timing and memory usage information
--no-plugins	Whether to disable plugins.
-d, --working-dir=WORKING-DIR	If specified, use the given directory as working directory.
--no-cache	Prevent use of the cache
-v vv vvv, --verbose	Increase the verbosity of messages: 1 for normal output, 2 for more verbose output and 3 for debug

Available commands:

about	Shows the short information about Composer.
archive	Creates an archive of this composer package.
browse	Opens the package's repository URL or homepage in your browser.
cc	Clears composer's internal package cache.
check-platform-reqs	Check that platform requirements are satisfied.
clear-cache	Clears composer's internal package cache.
clearcache	Clears composer's internal package cache.
config	Sets config options.
create-project	Creates new project from a package into given directory.
depends	Shows which packages cause the given package to be installed.
diagnose	Diagnoses the system to identify common errors.
dump-autoload	Dumps the autoloader.
dumpautoload	Dumps the autoloader.
exec	Executes a vendored binary/script.
fund	Discover how to help fund the maintenance of your dependencies.
global	Allows running commands in the global composer dir (\$COMPOSER_HOME).
help	Displays help for a command
home	Opens the package's repository URL or homepage in your browser.
i	Installs the project dependencies from the composer.lock file if present, or falls back on the composer.json.
info	Shows information about packages.
init	Creates a basic composer.json file in current directory.
install	Installs the project dependencies from the composer.lock file if present, or falls back on the composer.json.
licenses	Shows information about licenses of dependencies.
list	Lists commands
outdated	Shows a list of installed packages that have updates available, including their latest version.
prohibits	Shows which packages prevent the given package from being installed.
remove	Removes a package from the require or require-dev.
require	Adds required packages to your composer.json and installs them.
run	Runs the scripts defined in composer.json.
run-script	Runs the scripts defined in composer.json.
search	Searches for packages.
self-update	Updates composer.phar to the latest version.
selfupdate	Updates composer.phar to the latest version.
show	Shows information about packages.
status	Shows a list of locally modified packages, for packages installed from source.
suggests	Shows package suggestions.
u	Upgrades your dependencies to the latest version according to composer.json, and updates the composer.lock file.
update	Upgrades your dependencies to the latest version according to composer.json, and updates the composer.lock file.
upgrade	Upgrades your dependencies to the latest version according to composer.json, and updates the composer.lock file.
validate	Validates a composer.json and composer.lock.
why	Shows which packages cause the given package to be installed.
why-not	Shows which packages prevent the given package from being installed.

.ini Möglicherweise muss die gewählte php.ini angepasst werden:

```
; Notes for Windows environments :  
;  
; - Many DLL files are located in the extensions/ (PHP 4) or ext/ (PHP 5+)  
; extension folders as well as the separate PECL DLL download (PHP 5+).  
; Be sure to appropriately set the extension_dir directive.  
;  
;extension=bz2  
extension=curl  
;extension=ffi  
extension=fileinfo  
;extension=gd2  
;extension=gettext  
;extension=gmp  
;extension=intl  
;extension=imap  
;extension=ldap  
extension=mbstring  
;extension=exif ; Must be after mbstring as it depends on it  
;extension=mysqli  
;extension=oci8_12c ; Use with Oracle Database 12c Instant Client  
;extension=odbc  
extension=openssl  
;extension=pdo_firebird  
extension=pdo_mysql  
;extension=pdo_oci  
;extension=pdo_odbc  
;extension=pdo_pgsql  
;extension=pdo_sqlite  
;extension=pgsql  
;extension=shmop
```